

# DREAM

STABLE | ENERGY-SAVING | CLEAN | AND EFFICIENT

## GREEN ENERGY SHARED DREAM



### Dream (Shanghai) Compressor Co.,Ltd.

📍 International Sales & Operation Center:

Room 316, 3rd Floor, Building 1, Lane 288, Rongxing Road, Zhongshan Street,  
Songjiang District, Shanghai, China

Zhejiang Manufacturing Center:

No. 916, Chuangzhi Road, Xindai Town, Pinghu City, Jiaxing City, Zhejiang Province, China

☎ 86-13671551445

✉ sales@dmcomp.com



[www.dreamcompressor.com](http://www.dreamcompressor.com)  
[www.dmcomp.com](http://www.dmcomp.com)

Dream(Shanghai) Compressor Co.,Ltd.

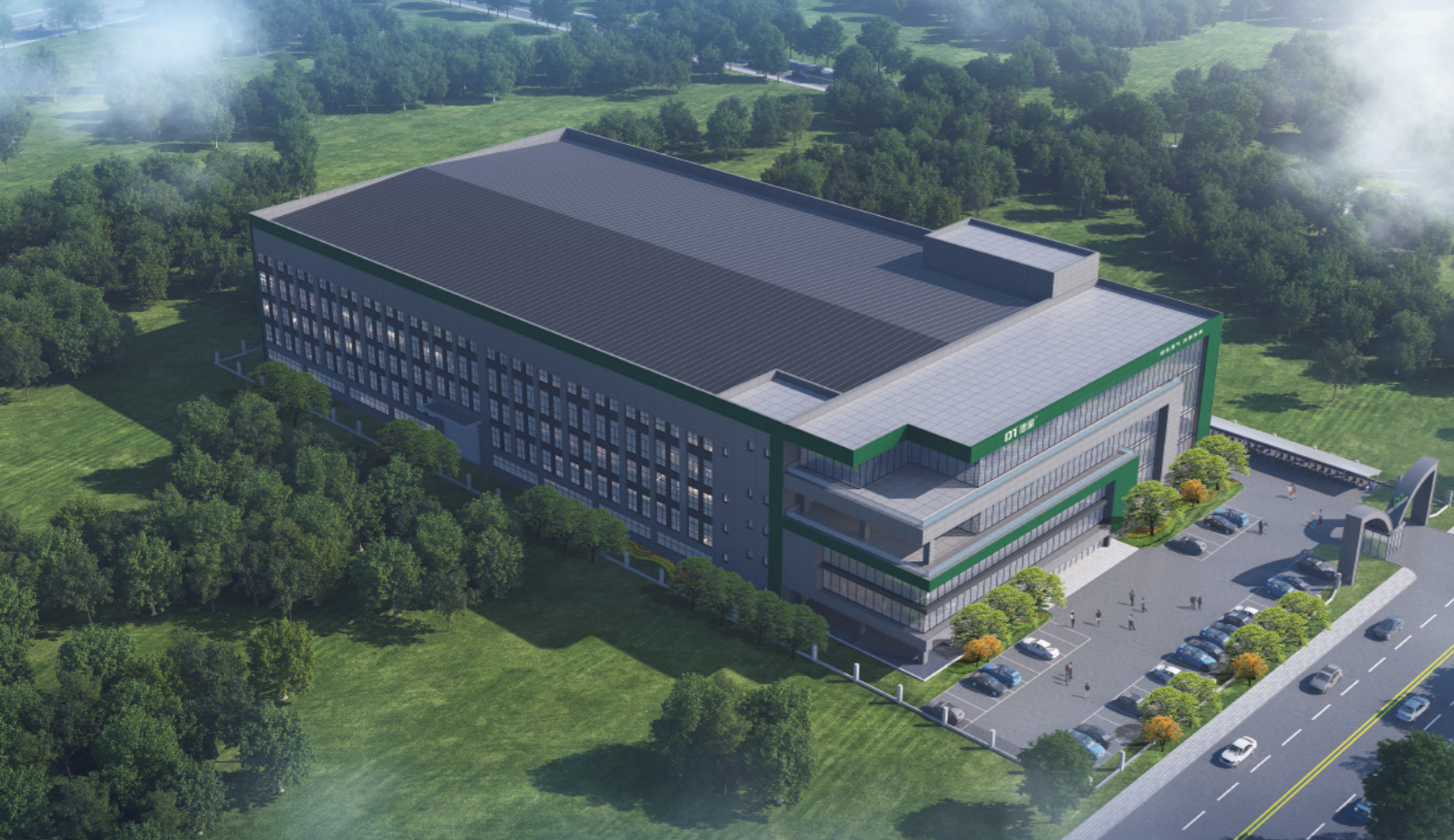

## ABOUT DREAM

 **45000** m<sup>2</sup>  
factory area

 **100+** 项  
Invention patents and honors

 **20+**  
Regional branches/subsidiaries

Dream (Shanghai) Compressor Co., Ltd. which established in Shanghai in 2011. It is a company specialized in designing, manufacturing and marketing of air compressors, is a high-tech enterprise that sells and provides system solutions.

It has won honors such as Shanghai Brand Cultivation Demonstration Enterprise, special new enterprise, energy-saving equipment contribution enterprise, high-tech achievement transformation project, etc. The products are widely used in new energy, chemical industry & chemistry, Electronics, textiles, brewing mill, laser cutting, medicine & food and other fields.

Based on concepts of stable, energy-saving, clean, efficiency, simple operation & maintenance, DREAM insists on developing based on market demand and innovation. The company invests 10%-15% of its profits every year into R&D and the upgrading & optimization of products. Innovation is the main driver for DREAM's growth. As a manufacturer supplier of Air compressor system solutions, our service covers client requirement analysis, site investigation, technical solution design, and project cost analysis, non-standard solution customization, solution demonstration and promotion. We provide exclusive compressed gas solutions based on project needs.

After development for 14+ years, Dream has always adhered to the enterprise spirit of "One heart One Dream, striving for excellence", constantly innovating and pursuing excellence. Dream people continue to explore and innovate to meet customer needs and provide users with better products and service. Based in China, Dream's products have been exported to worldwide countries successfully, mainly market as South Asia, South East Asia, Europe, Africa, South America, North America, and CIS countries, footprints all over the world. Its excellent product performance and efficient service concept continue to create value for users.

Dream will be always your trust partner. We believe that you will experience our high-quality products and professional services, by working with us. Welcome to pursue dream and create better future with DREAM together!

## DREAM CULTURE



### Vision

To be a highly competitive manufacturer supplier for air compressor system solutions



### Mission

Give users more worry free Sustainably save energy and gas



### Value

Concentric shared dream professional focused co-created shared

# DREAM

GREEN ENERGY SHARED DREAM

## Enterprise honor

- High-tech enterprise
- Specialized in special new enterprises
- Energy-saving technology and equipment contributing enterprises
- Shanghai brand cultivation model enterprise
- CE Certificates
- EMC Certificates
- TUV Rheinland Class 0 Oil Free Certificates
- Germany TUV product safety certification
- GCCA product quality and safety certification
- ISO 9001,14001,45001

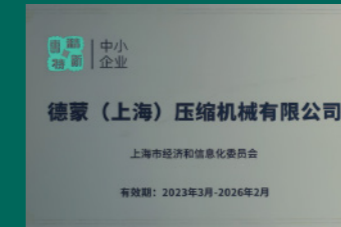
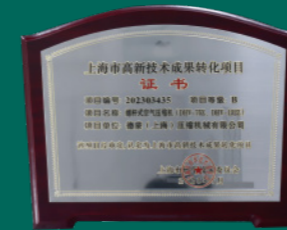
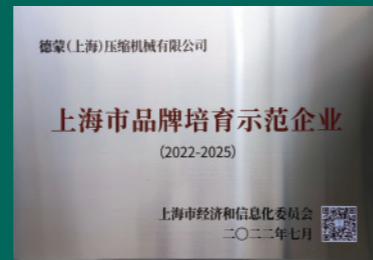

**20+**  
City subsidiary

**34** Provincial sales  
service network

Adhering to the business philosophy of "market-oriented,customer-centric,technical support and service guarantee",Dream is committed to providing customers with high quality products and industry-leading services. With Shanghai as the center and 20 service outlets nationwide as the auxiliary,Dream covers 34 provinces and autonomous regions of China's sales and service network,dedicated to provide customers with better service.

## Global service

Dream is committed to providing quality products and services on a global scale,and has conducted overseas operations in many countries and regions,including Southeast Asia,Eu-rope,and the Americas,and has established strong partnerships in overseas markets. Our overseas agents have rich experience in cross-cultural communication and international vision,and are able to better understand and meet the needs of local customers and markets. In the future,we will continue to strengthen the development of overseas business,expand more overseas markets,and let China intelligent manufacturing shine on the international stage.



## Development history

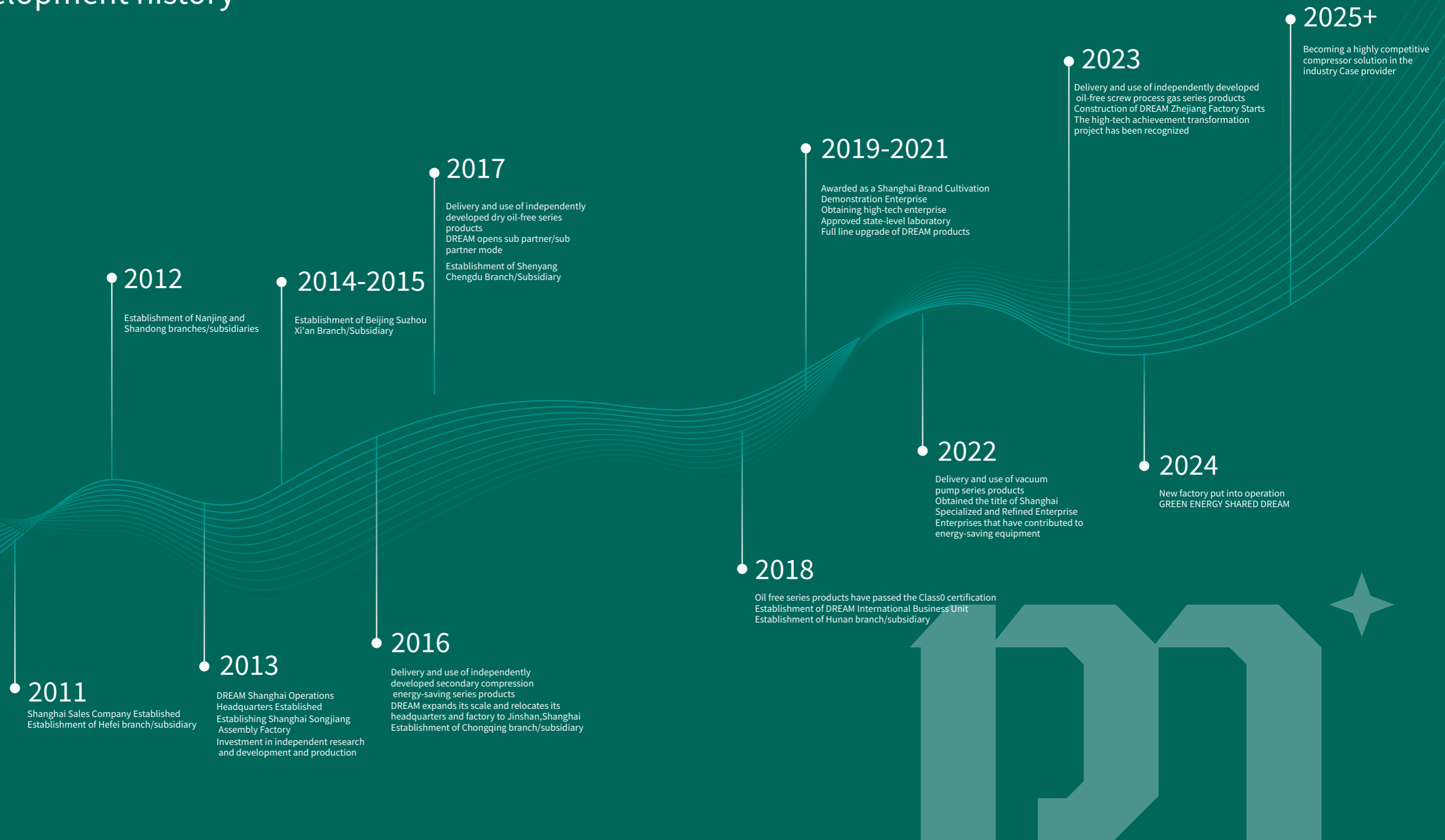

# DREAM

## Partner



# GREEN ENERGY SHARED DREAM

## Service areas



New energy



Chemical Engineering&Chemistry



Electronic manufacturing

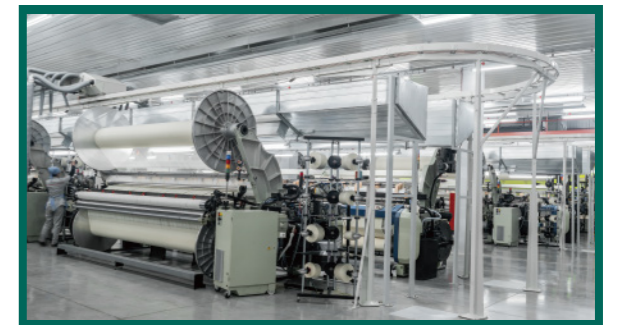

Textile industry



Brewing industry



Food industry



Pharmaceutical Industry



Electricity

## Dream Intelligent Manufacturing Six core competencies



## | Full process cycle and service

We provide the whole process cycle service for customers to build gas stations or upgrade, covering compressed gas system research, evaluation, design, edge calculation, equipment installation, engineering installation, intelligent iot system control, equipment maintenance and so on.

## | Service process

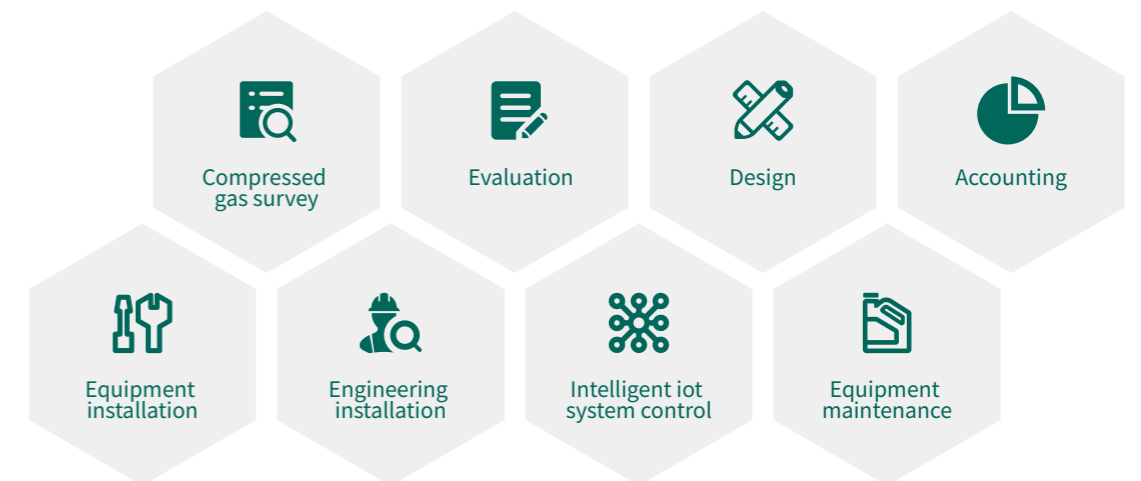

## | Performance pledge

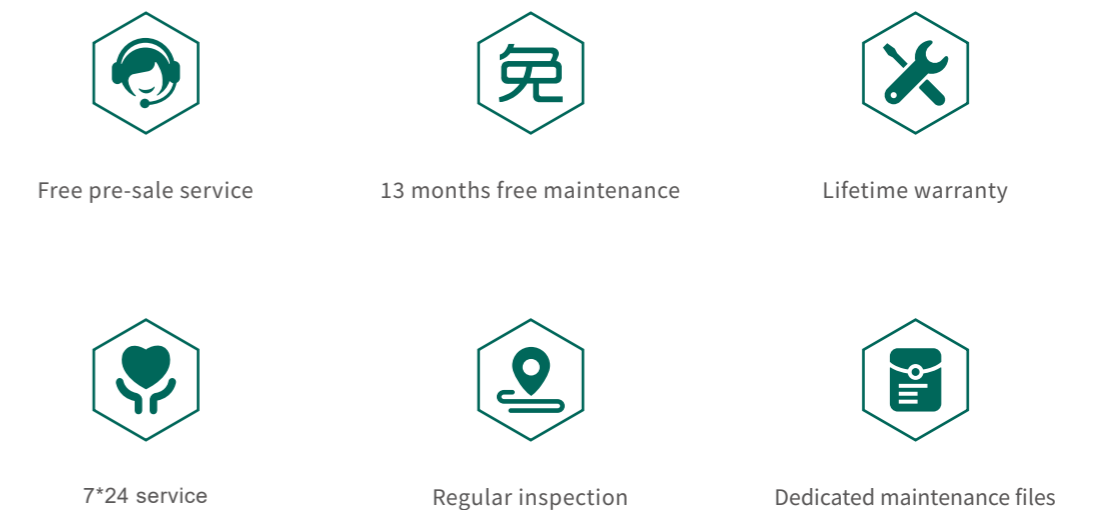



(Inlet pressure) :  $\leq 0.6\sim 1.0\text{Mpa}$   
 (Inlet temperature) :  $\leq 45^{\circ}\text{C}$   
 (Purge air) :  $\leq 3\sim 5^{\circ}\text{C}$   
 ( Pressure dew point) :  $-40^{\circ}\text{C}\sim -70^{\circ}\text{C}$   
 (Cooling Water temperature) :  $\leq 32^{\circ}\text{C}$   
 (Pressure drop) :  $\leq 0.05\text{Mpa}$

## DM-XZH series

### intelligent combination dryer

There is a stable outlet dew point and a lower and more stable pressure dew point. The large capacity of the desiccant ensures that the air and the desiccant have sufficient contact space to fully absorb water. Minimal regenerative air consumption. Long service life of adsorbent, unique design of removable stainless steel diffuser, uniform distribution of gas in the tower, to avoid the wear of adsorbent after ditch flow.



Integrated design of cold dryer and suction dryer



Small volume



No need to install intermediate pipelines



Lower pressure dew point for greater stability



DM-XZH series	Air capacity	Cooling water flow rate	Air outlet pipe diameter	net weight	dimensions(mm)		
	Nm <sup>3</sup> /min			m <sup>3</sup> /h	kg	length	width
DM-1XZH	1.5	Air-cooled	ZG1" (Inside screw thread)	295	980	750	1455
DM-2XZH	2.6		ZG1" (Inside screw thread)	350	980	800	1655
DM-3XZH	3.8		ZG1 1/2" (Inside screw thread)	485	1200	1000	1535
DM-6XZH	6.5		DN50	655	1200	1000	1995
DM-10XZH	11		DN65	750	1460	1180	2065
DM-16XZH	17	3	DN80	950	1800	1320	2205
DM-20XZH	23	3.5	DN80	1220	1750	1800	2150
DM-30XZH	33	6	DN100	1460	2050	1650	2450
DM-40XZH	45	7.4	DN125	1980	2420	1830	2706
DM-50XZH	55	8	DN125	2500	2520	1900	2750
DM-60XZH	65	10	DN125	2950	2550	1900	2780
DM-80XZH	85	12	DN150	3550	2650	2400	2800

## Energy Conservation

Air compressors are the "electric tigers" in industrial electricity consumption, with an average power consumption of 20%. We have made a series of efforts and research on how to use the same electricity to create more air to help users save energy, and have made important breakthroughs. The permanent magnet variable frequency screw machine developed by the company can save users about 25-35% of electricity while ensuring the original work efficiency.



intelligent control



Rust proof shell



Efficient and energy-saving



Constant current and stable voltage



Easy to use and worry free



reduce the noise

## Energy saving and cost reduction

When purchasing an air compressor, the traditional cost (i.e. purchase cost+maintenance cost) only accounts for 7% of the total cost, while energy consumption accounts for 93%. The two-stage compression direct connection/permanent magnet screw air compressor saves 25-30% energy compared to ordinary (power frequency) air compressors.

— taking 75KW as an example

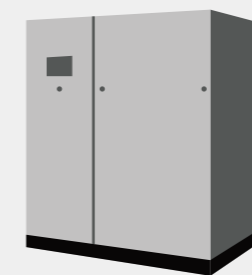
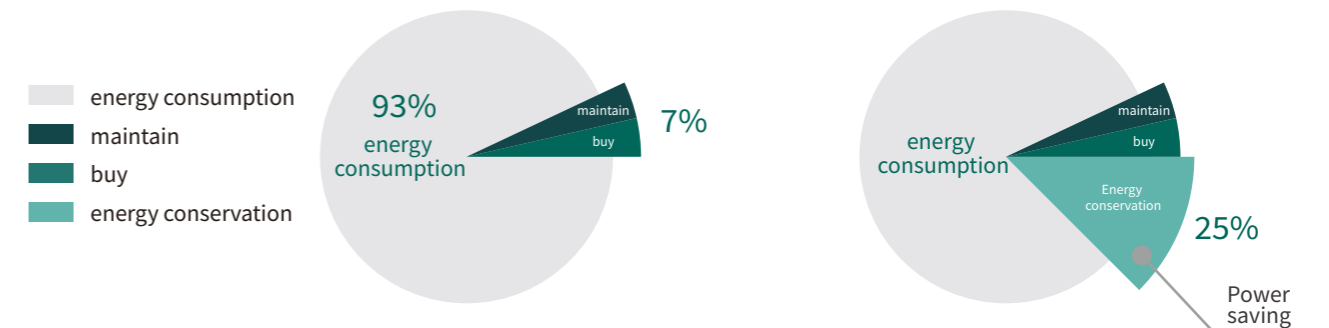

Ordinary (power frequency) air compressor



Dream air compressor



Desmond 75KW air compressor  
It saves about 25% of electricity a year