

# DREAM

STABLE | ENERGY-SAVING | CLEAN | AND EFFICIENT

## GREEN ENERGY SHARED DREAM



### Dream (Shanghai) Compressor Co.,Ltd.

International Sales & Operation Center:

Room 316, 3rd Floor, Building 1, Lane 288, Rongxing Road, Zhongshan Street,  
Songjiang District, Shanghai, China

Zhejiang Manufacturing Center:

No. 916, Chuangzhi Road, Xindai Town, Pinghu City, Jiaxing City, Zhejiang Province, China

86-13671551445

sales@dmcomp.com



[www.dreamcompressor.com](http://www.dreamcompressor.com)  
[www.dmcomp.com](http://www.dmcomp.com)

Dream(Shanghai) Compressor Co.,Ltd.

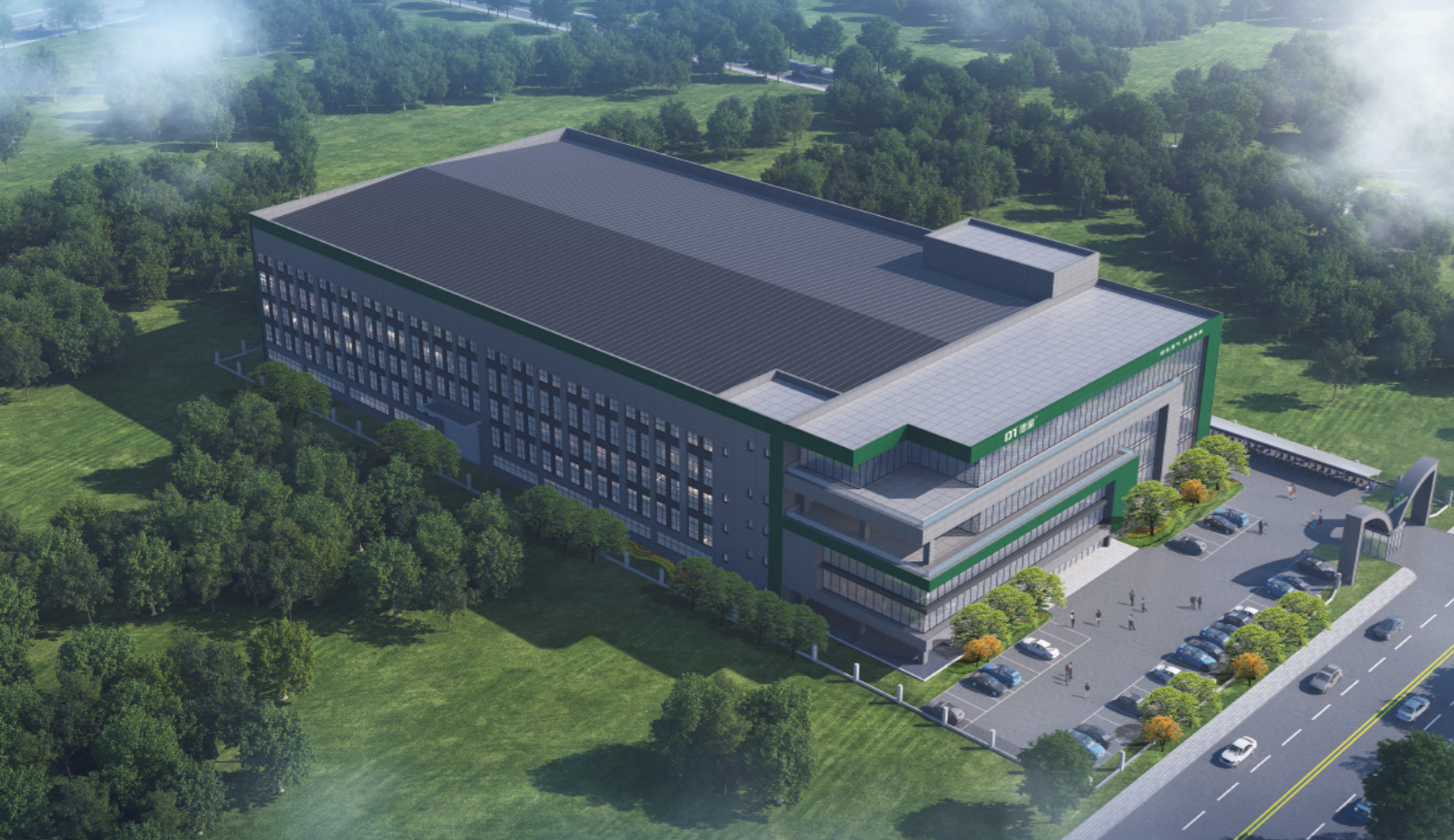

## ABOUT DREAM

 **45000** m<sup>2</sup>  
factory area

 **100+** 项  
Invention patents and honors

 **20+**  
Regional branches/subsidiaries

Dream (Shanghai) Compressor Co., Ltd. which established in Shanghai in 2011. It is a company specialized in designing, manufacturing and marketing of air compressors, is a high-tech enterprise that sells and provides system solutions.

It has won honors such as Shanghai Brand Cultivation Demonstration Enterprise, special new enterprise, energy-saving equipment contribution enterprise, high-tech achievement transformation project, etc. The products are widely used in new energy, chemical industry & chemistry, Electronics, textiles, brewing mill, laser cutting, medicine & food and other fields.

Based on concepts of stable, energy-saving, clean, efficiency, simple operation & maintenance, DREAM insists on developing based on market demand and innovation. The company invests 10%-15% of its profits every year into R&D and the upgrading & optimization of products. Innovation is the main driver for DREAM's growth. As a manufacturer supplier of Air compressor system solutions, our service covers client requirement analysis, site investigation, technical solution design, and project cost analysis, non-standard solution customization, solution demonstration and promotion. We provide exclusive compressed gas solutions based on project needs.

After development for 14+ years, Dream has always adhered to the enterprise spirit of "One heart One Dream, striving for excellence", constantly innovating and pursuing excellence. Dream people continue to explore and innovate to meet customer needs and provide users with better products and service. Based in China, Dream's products have been exported to worldwide countries successfully, mainly market as South Asia, South East Asia, Europe, Africa, South America, North America, and CIS countries, footprints all over the world. Its excellent product performance and efficient service concept continue to create value for users.

Dream will be always your trust partner. We believe that you will experience our high-quality products and professional services, by working with us. Welcome to pursue dream and create better future with DREAM together!

## DREAM CULTURE



### Vision

To be a highly competitive manufacturer supplier for air compressor system solutions



### Mission

Give users more worry free Sustainably save energy and gas



### Value

Concentric shared dream professional focused co-created shared

# DREAM

## Enterprise honor

- High-tech enterprise
- Specialized in special new enterprises
- Energy-saving technology and equipment contributing enterprises
- Shanghai brand cultivation model enterprise
- CE Certificates
- EMC Certificates
- TUV Rheinland Class 0 Oil Free Certificates
- Germany TUV product safety certification
- GCCA product quality and safety certification
- ISO 9001,14001,45001

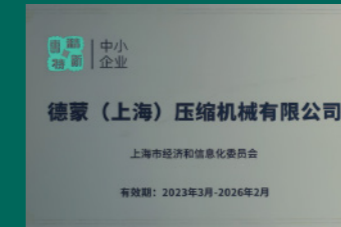
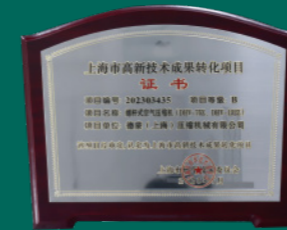
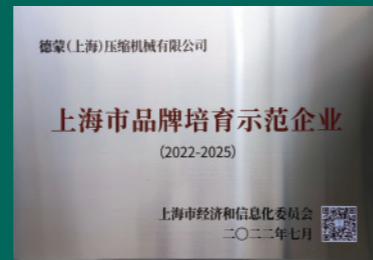

**20+**  
City subsidiary

**34** Provincial sales  
service network

Adhering to the business philosophy of "market-oriented, customer-centric, technical support and service guarantee", Dream is committed to providing customers with high quality products and industry-leading services. With Shanghai as the center and 20 service outlets nationwide as the auxiliary, Dream covers 34 provinces and autonomous regions of China's sales and service network, dedicated to provide customers with better service.

## Global service

Dream is committed to providing quality products and services on a global scale, and has conducted overseas operations in many countries and regions, including Southeast Asia, Europe, and the Americas, and has established strong partnerships in overseas markets. Our overseas agents have rich experience in cross-cultural communication and international vision, and are able to better understand and meet the needs of local customers and markets. In the future, we will continue to strengthen the development of overseas business, expand more overseas markets, and let China intelligent manufacturing shine on the international stage.



## Development history

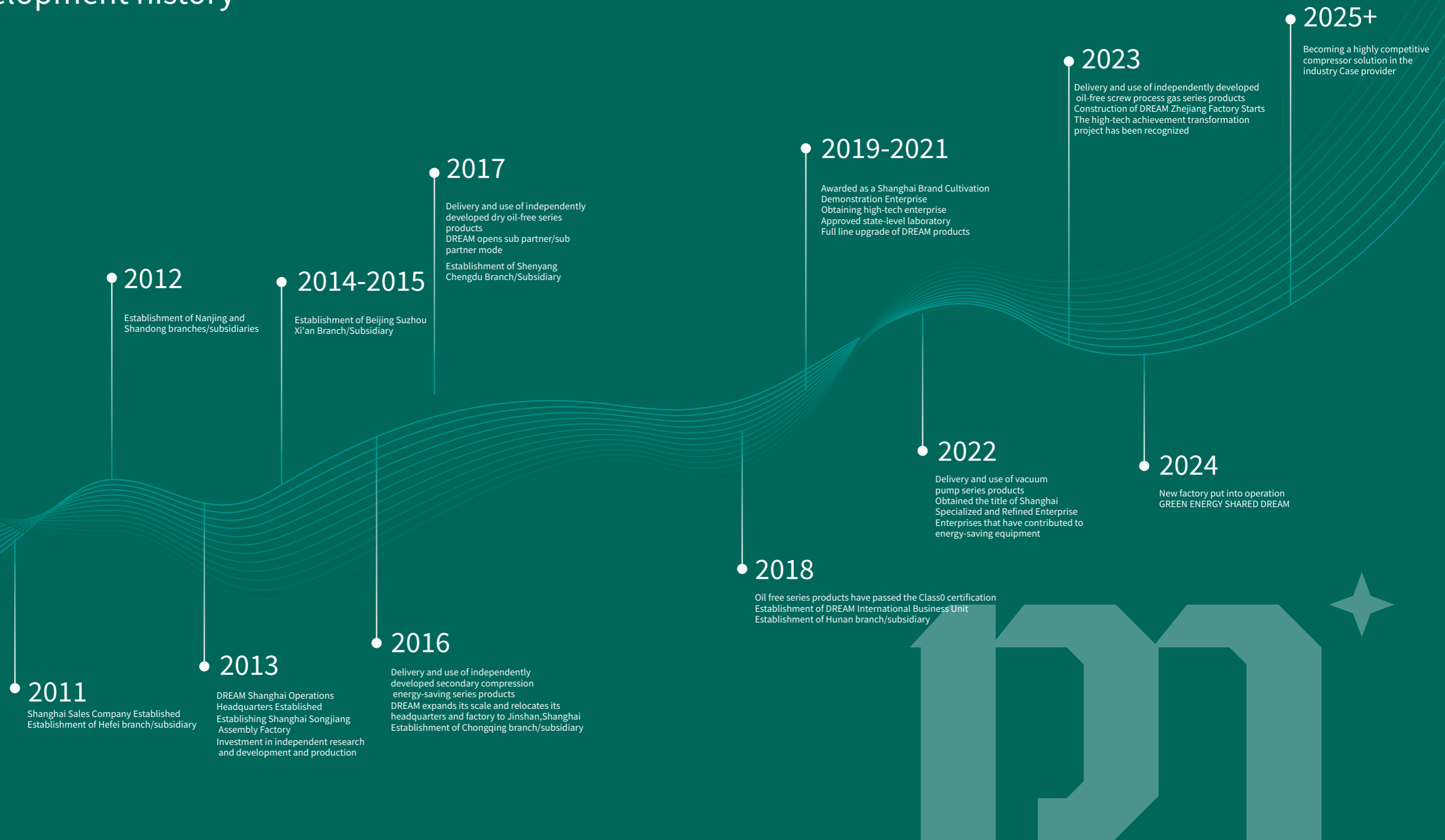

# DREAM

## Partner



# GREEN ENERGY SHARED DREAM

## Service areas



New energy



Chemical Engineering&Chemistry



Electronic manufacturing

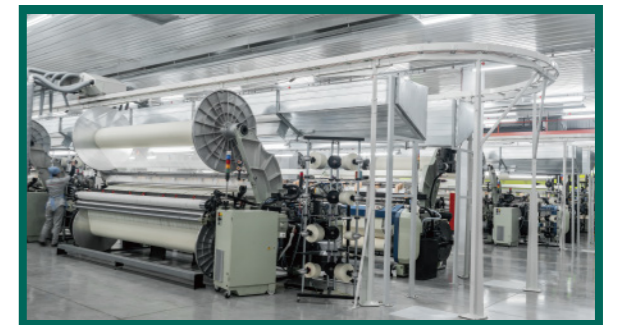

Textile industry



Brewing industry



Food industry



Pharmaceutical Industry



Electricity

## Dream Intelligent Manufacturing Six core competencies



## | Full process cycle and service

We provide the whole process cycle service for customers to build gas stations or upgrade, covering compressed gas system research, evaluation, design, edge calculation, equipment installation, engineering installation, intelligent iot system control, equipment maintenance and so on.

## | Service process

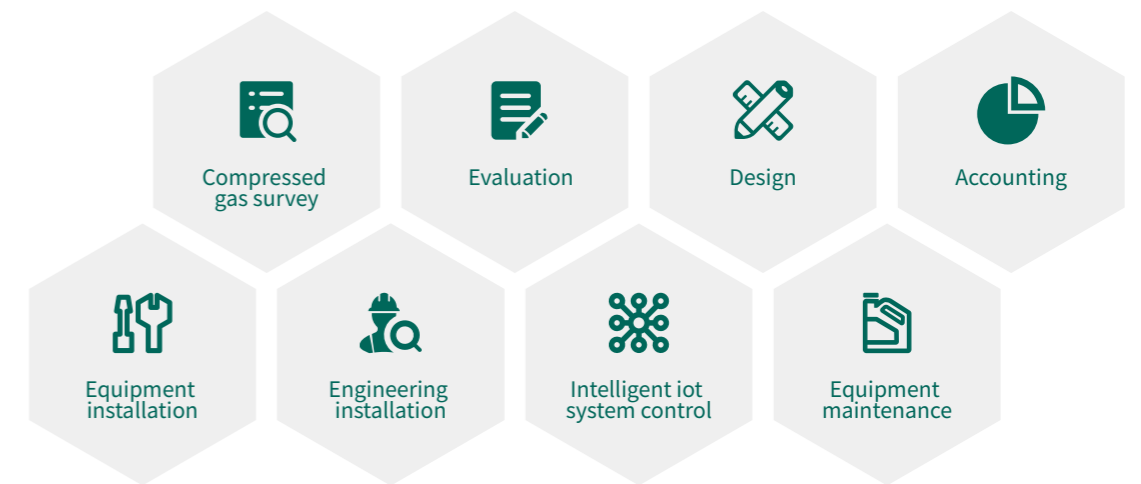

## | Performance pledge

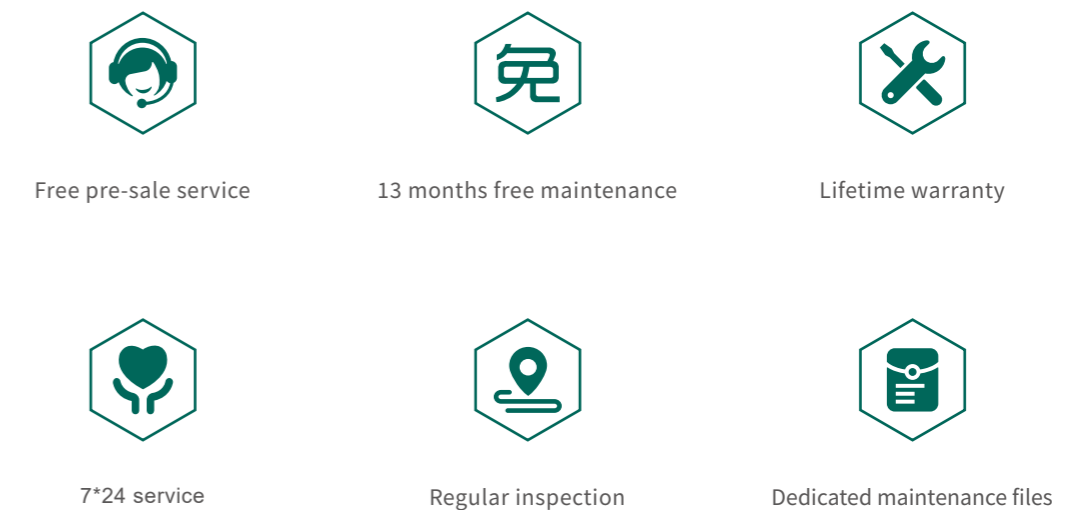

## water-cooled

The design structure of the air storage tank makes the air storage process more stable, and can cope with air pressure fluctuations under different working conditions to ensure the stable operation of the system. The air storage tank can flexibly adjust the pressure of the released air by adjusting the pressure control mechanism of the intake and outlet. It is suitable for different working scenarios and can meet the requirements of different devices.



**material:**  
Carbon steel: Q253B/Q345R  
stainless steel: S30408



Reliable and durable pressure vessel



solid



non-corrosive

Specifications Volume (m <sup>3</sup> ) / pressure(MPa)	Design temperature °C	Total container height Height(mm)	Container bore φ (mm)	Air inlet			Air outlet		
				H2 (mm)	DN	threaded	H3(mm)	DN	threaded
0.3/0.8	110	1530	550	542	50	Rp1 1/2"	1142	50	Rp1 1/2"
0.3/1.0		1530		542			1142		
0.3/1.3		1530		542			1142		
0.3/1.6		1530		542			1142		
0.6/0.8	110	1965	650	552	50	Rp1 1/2"	1552	65	Rp1 1/2"
0.6/1.0		1907		552			1552		
0.6/1.3		1909		552			1552		
0.6/1.6		2086		552			1552		
1.0/0.8	110	2150	800	640	65	Rp2"	690	65	Rp2"
1.0/1.0		2150		640			690		
1.0/1.3		2150		640			690		
1.0/1.6		2150		640			691		

1.5/0.8	110	2265	950	747	65	Rp2"	1807	65	Rp2"
1.5/1.0		2265		747			1807		
1.5/1.3		2265		747			1807		
1.5/1.6		2565		749			1809		
2.0/0.8	110	2780	1000	760	80	Rp2"	2320	80	Rp2"
2.0/1.0		2780		760			2320		
2.0/1.3		2782		761			2321		
2.0/1.6		2786		763			2323		
2.5/0.8	110	3300	1000	760	80	/	2840	80	/
2.5/1.0		3300		760			2840		
2.5/1.3		3302		761			2841		
2.5/1.6		2836		800			788		

3.0/0.8	110	2920	1200	850	80	/	2410	80	/
3.0/1.0		2922		851			2411		
3.0/1.3		2924		852			2412		
3.0/1.6		2926		853			2413		
4.0/0.8	110	3030	1400	910	100	/	2470	100	/
4.0/1.0		3032		911			2471		
4.0/1.3		3036		913			2473		
4.0/1.6		3040		915			2475		
5.0/0.8	110	3630	1400	910	100	/	2990	100	/
5.0/1.0		3632		911			2991		
5.0/1.3		3636		913			2993		
5.0/1.6		3640		915			2995		

## Energy Conservation

Air compressors are the "electric tigers" in industrial electricity consumption, with an average power consumption of 20%. We have made a series of efforts and research on how to use the same electricity to create more air to help users save energy, and have made important breakthroughs. The permanent magnet variable frequency screw machine developed by the company can save users about 25-35% of electricity while ensuring the original work efficiency.



intelligent control



Rust proof shell



Efficient and energy-saving



Constant current and stable voltage



Easy to use and worry free



reduce the noise

## Energy saving and cost reduction

When purchasing an air compressor, the traditional cost (i.e. purchase cost+maintenance cost) only accounts for 7% of the total cost, while energy consumption accounts for 93%. The two-stage compression direct connection/permanent magnet screw air compressor saves 25-30% energy compared to ordinary (power frequency) air compressors.

— taking 75KW as an example

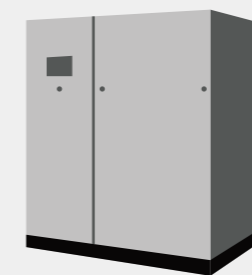
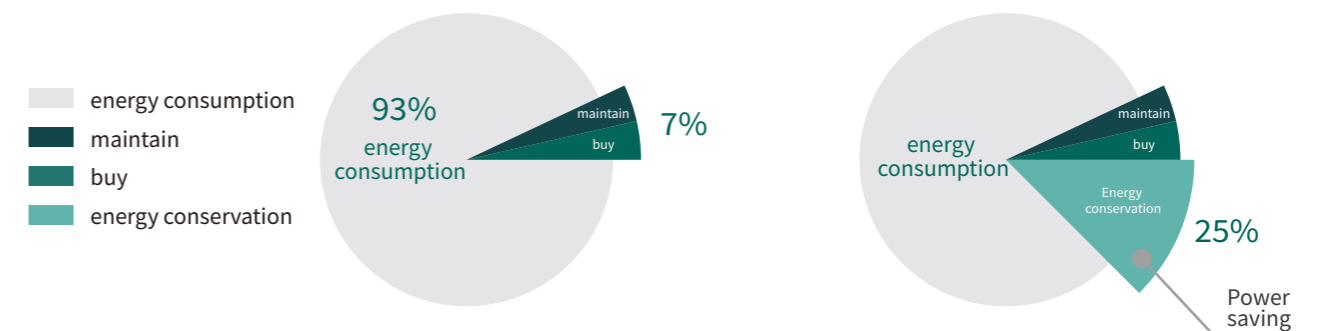

Ordinary (power frequency) air compressor



Dream air compressor



Desmond 75KW air compressor  
It saves about 25% of electricity a year